

2 Wall Section
3/4" = 1'-0"

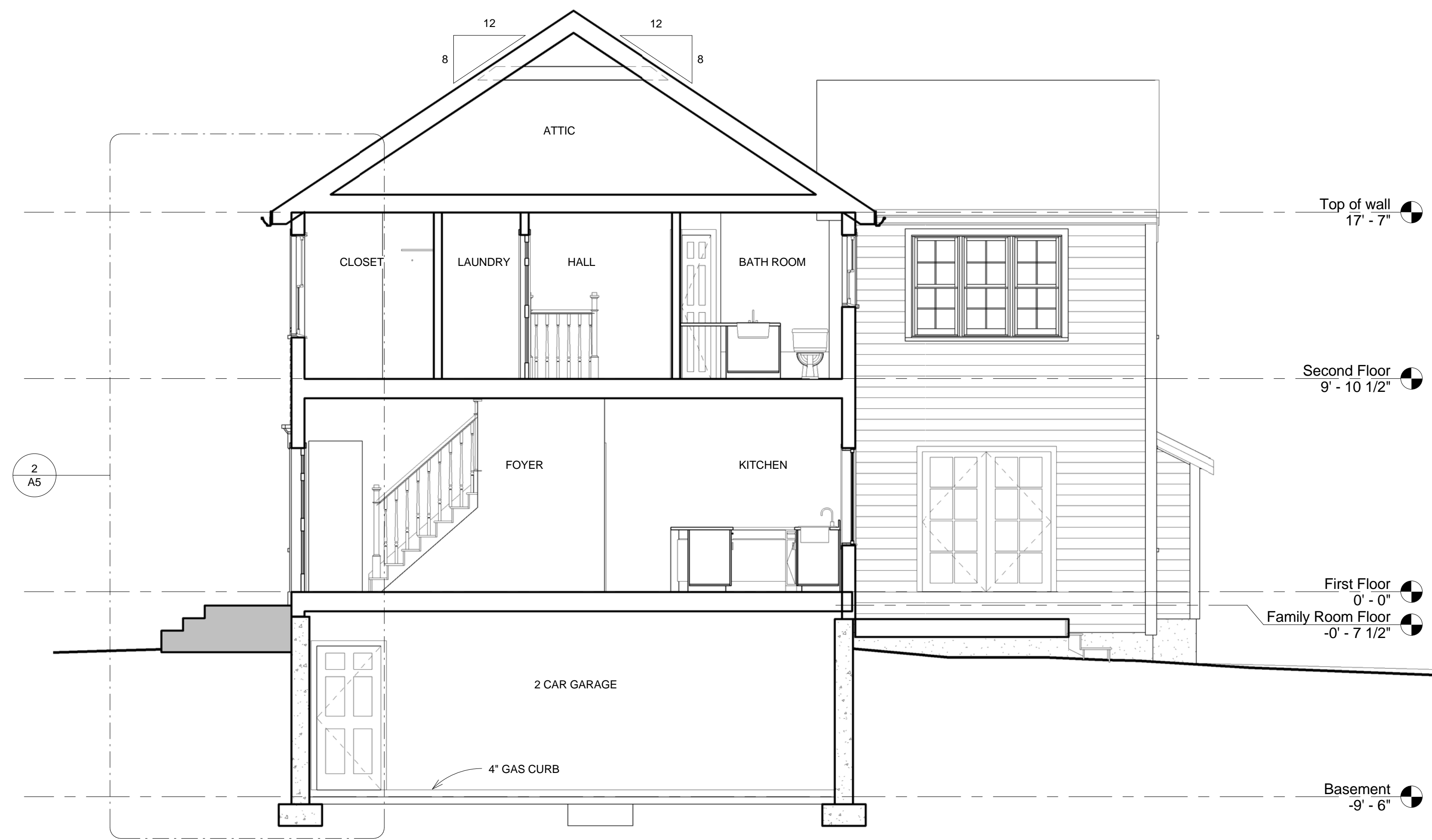

1 Cross Section
1/4" = 1'-0"

McClentick Architectural Design
2000 Pope Court Clayton, NC 27520
phone 339 987-0437
www.mcclentickdesign.com



K & E Construction
Bates Lane
Building & Wall Sections

Project number 2011R005
Date 05-05-11
Drawn by DAM
Checked by DAM

A5

Scale As indicated