

REVIT PRINTING ISSUE

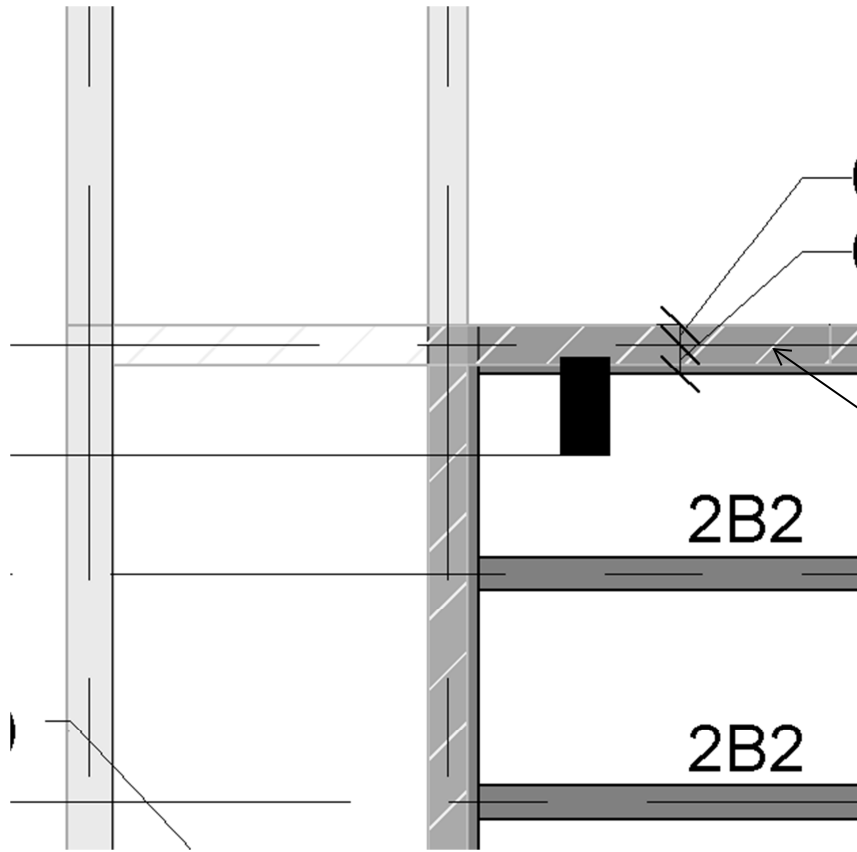

REVIT 2013 SCREEN VIEW

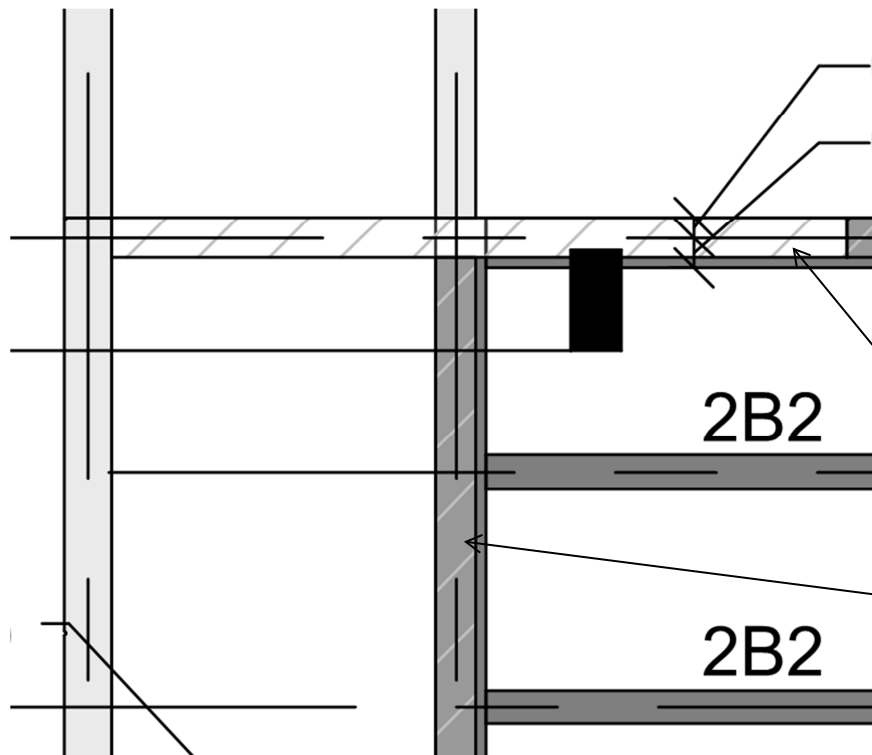

REVIT 2013 PRINTED VIEW

Some show up as white, but hatching is still visible.

Some print correctly.

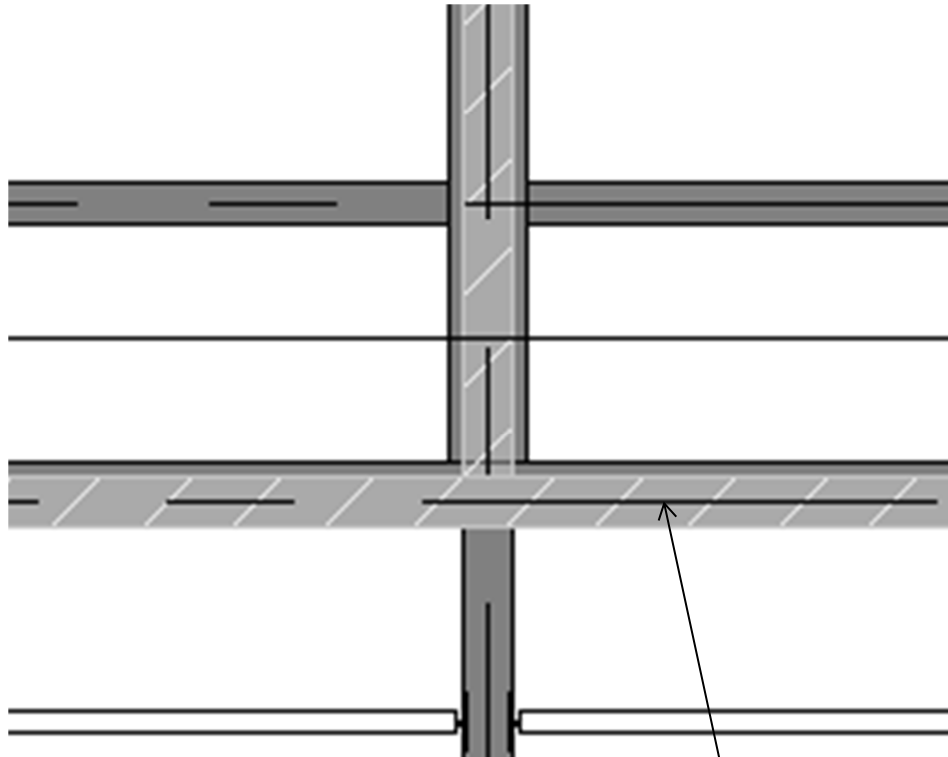

REVIT 2013 SCREEN VIEW

This happens randomly with the walls that I've overridden. Sometimes this includes an entire wall, others it happens in different sections of the same wall.

I've tried printing this to our paper printer and with Bluebeam and it comes out the same incorrect way.

Same situation, different area.

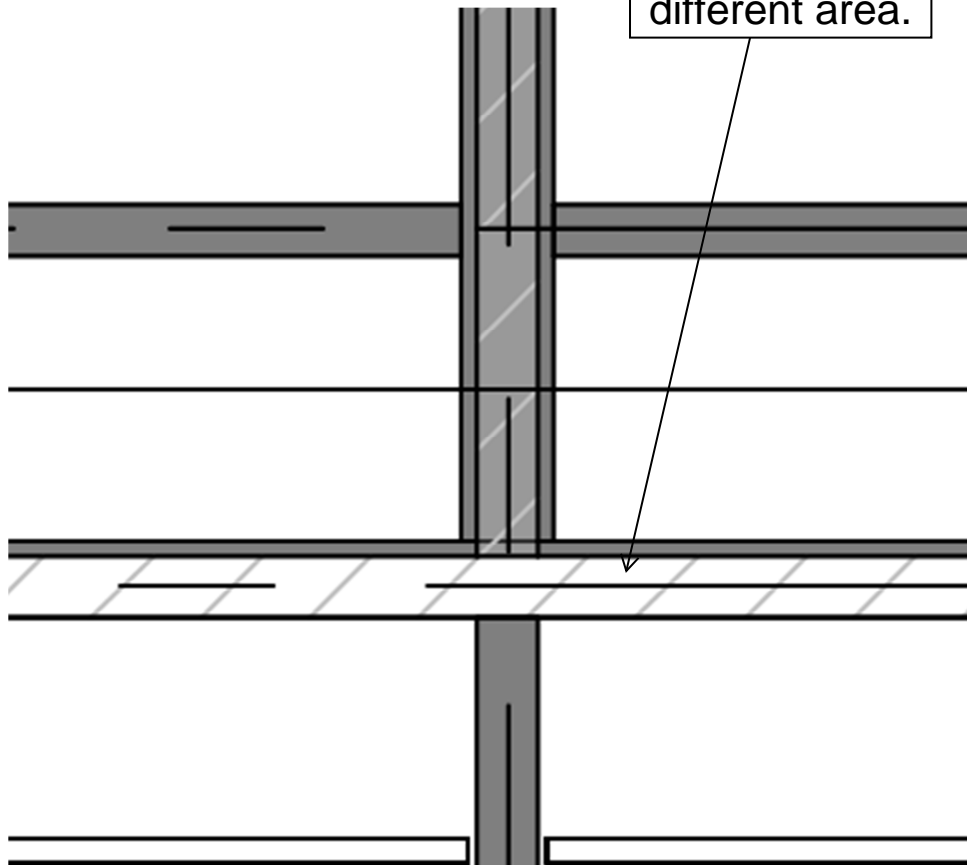

REVIT 2013 PRINTED VIEW

I need to use the overrides because of the custom areas I have to hatch and shade. I believe it's some print setting that's causing this to happen, because the walls are the exact same and some show up correctly and some don't.

Please advise me if you've experienced this before and know how to fix it.